

# McDowell Road Sidewalk Revitalization - 7th St to SR-51

## Concept 3 - 7ft Sidewalk With Lane Modification

**DRAFT**

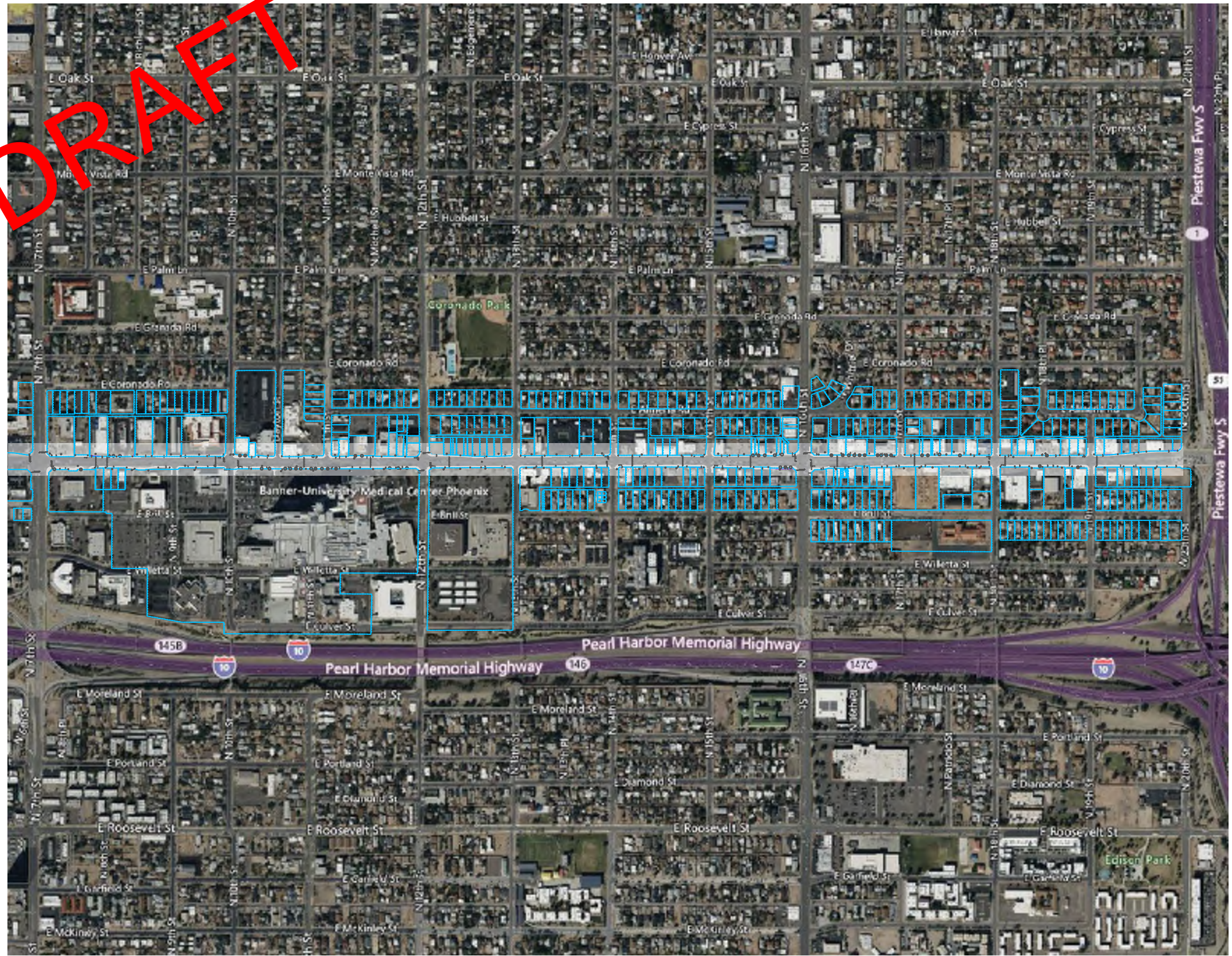

### Quantities

①③	Street Light Relocation:	28
②③	Fire Hydrant Relocation:	4
④③	Signal Cabinet Relocation:	1
⑤③	Water Main Relocation:	1
⑦	Potential Private Infrastructure Conflict:	23
⑩	Proposed Traffic Signal Improvement:	4
⑪	Proposed HAWK	2
⑫	Proposed Box Tree	49
⑬	Proposed Median Improvement:	2
	Proposed Sidewalk Within Existing Right of Way	8,625 sqft
⑰	Existing Sidewalk	120,427 sqft
	Proposed Sidewalk Within Existing Easement	512 sqft
⑭	Pedestrian Scale Lights	162
	Proposed Sidewalk Outside Existing Right of Way	3,116 sqft

### Legend

- Existing Right of Way Lines
- Existing Easement Lines
- Proposed 7ft Sidewalk Extents

**Michael Baker**  
INTERNATIONAL

DESIGNED BY: SS	ISSUE DATE: 5/31/2023
DRAWN BY: SS	SOLICITATION NO.:
CHECKED BY: JF	CONTRACT NO.:
SUBMITTED BY: JF	SIZE:

**Concept 3**

SHEET ID  
0

**DRAFT**

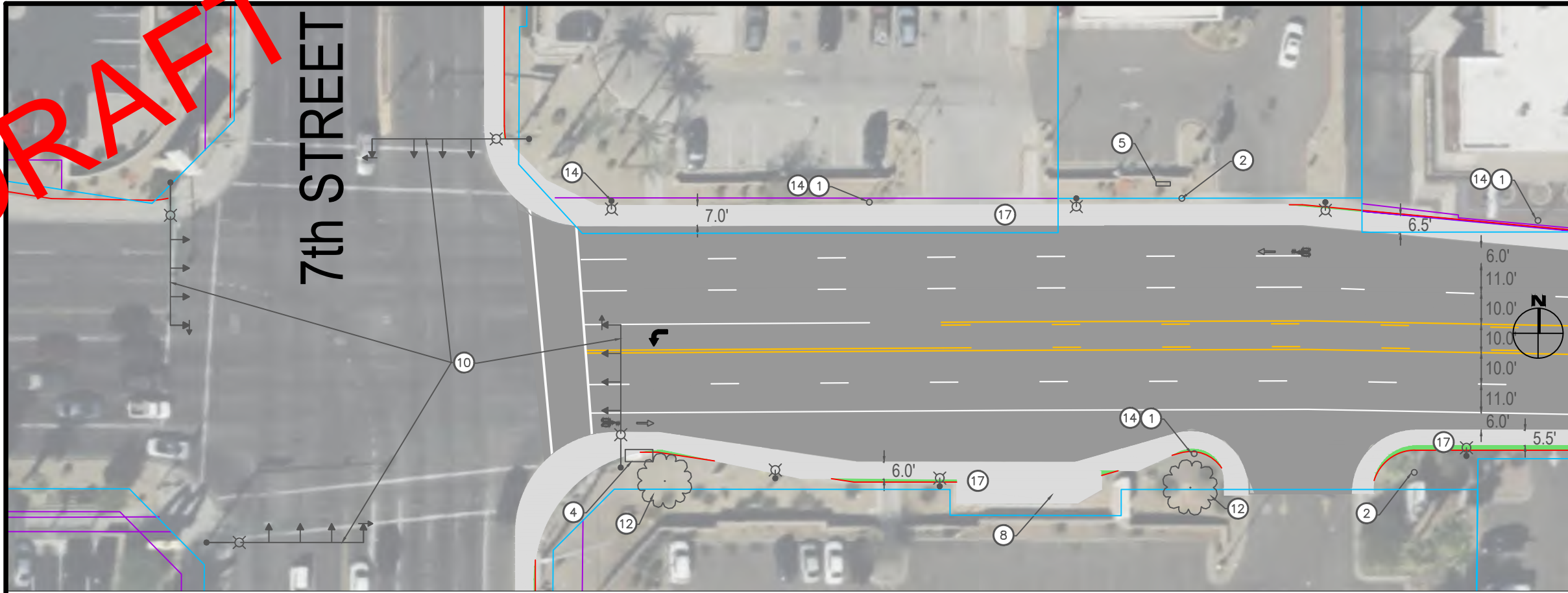

McDowell Road

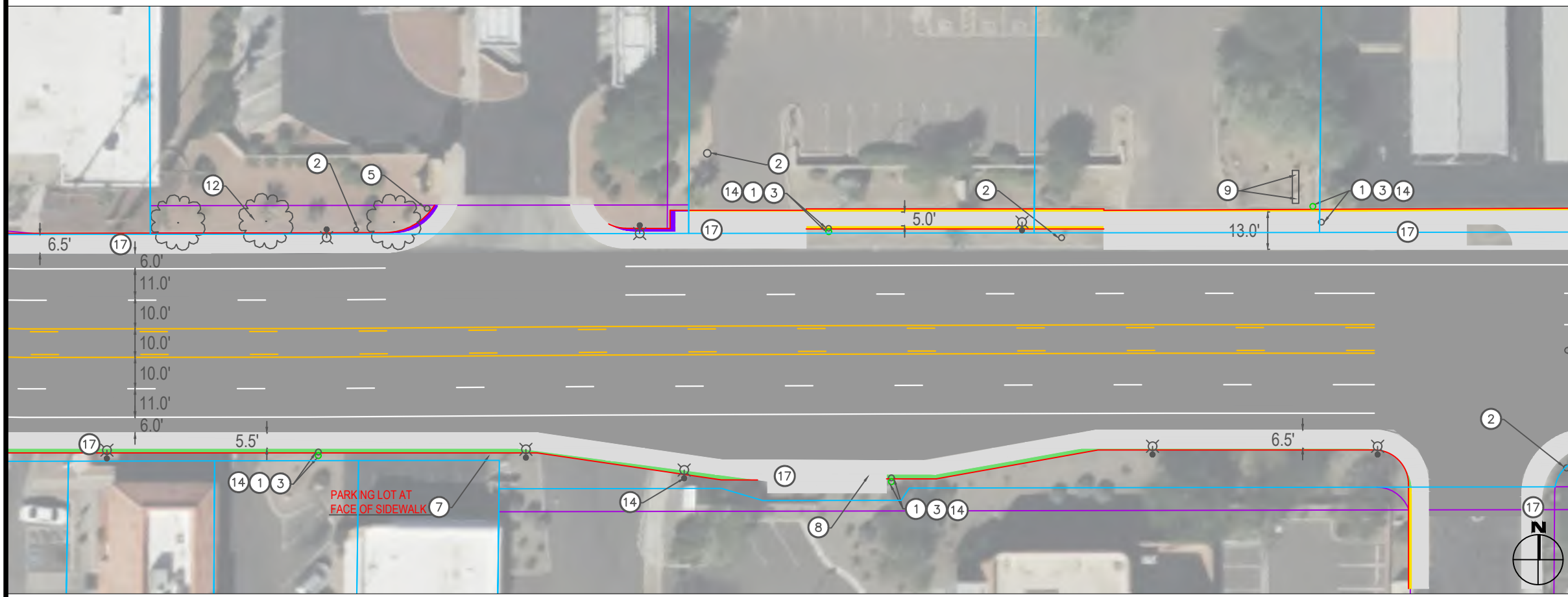

**Construction Notes**

- ① Existing Streetlight
- ② Existing Fire Hydrant
- ③ Relocate existing utility behind new sidewalk offset
- ④ Existing Traffic Signal Cabinet
- ⑤ Existing Water Main
- ⑥ Existing Concrete Utility Box
- ⑦ Potential Private Infrastructure Conflict, description per plan
- ⑧ Existing Bus Stop
- ⑨ Existing Irrigation Box
- ⑩ Proposed Signal Improvements
- ⑫ Proposed Box Tree, typical
- ⑭ Pedestrian Scale Light
- ⑰ Existing Sidewalk

**Quantities**

- ① ③ 4
- ② ③ 0
- ④ ③ 0
- ⑤ ③ 0
- ⑦ 1
- ⑩ 1
- ⑪ 0
- ⑫ 5
- ⑭ 21
- ⑰ 14,620 sqft
- ① ③ ⑭ 436 sqft (Outside RoW)
- ② ③ ⑭ 738 sqft (Inside RoW)
- ③ ④ ⑤ ⑥ ⑦ ⑧ ⑨ ⑩ ⑪ ⑫ ⑬ ⑭ ⑮ ⑯ ⑰ 131 sqft (Inside Easement)

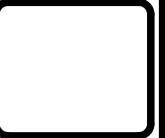
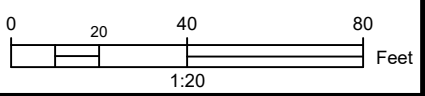

**Michael Baker  
INTERNATIONAL**

DESIGNED BY: SS	ISSUE DATE: 5/6/23
DRAWN BY: SS	SOLICITATION NO.:
CHECKED BY: JF	CONTRACT NO.:
SUBMITTED BY: JF	SIZE:

**7ft Sidewalk**

SHEET ID  
**1**

**DRAFT**

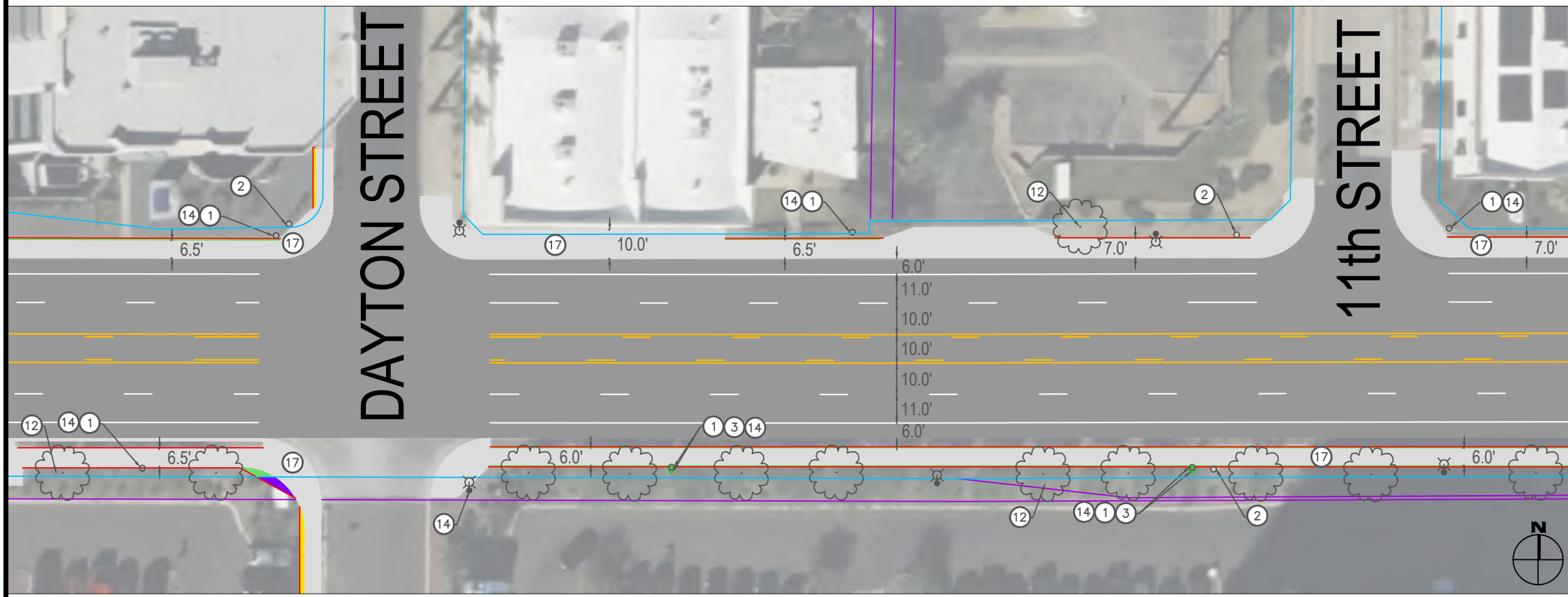
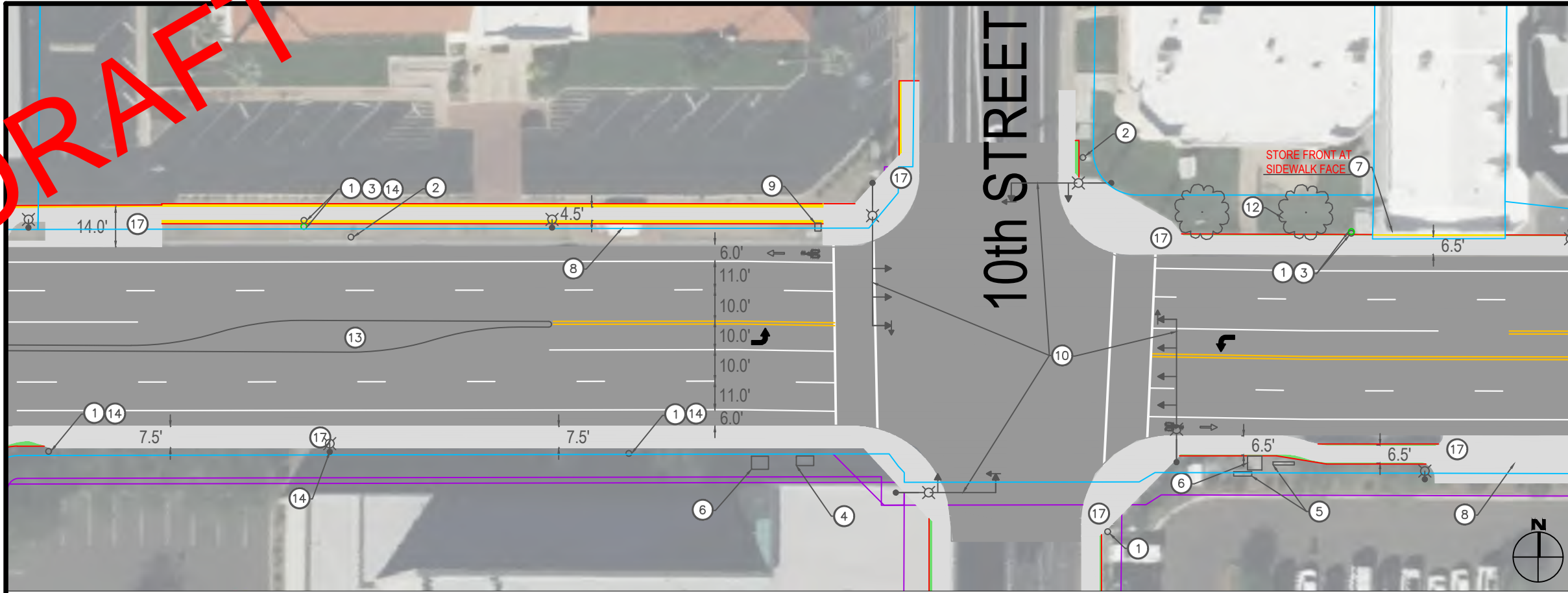

**Construction Notes**

- ① Existing Streetlight
- ② Existing Fire Hydrant
- ③ Relocate existing utility behind new sidewalk offset
- ④ Existing Traffic Signal Cabinet
- ⑤ Existing Water Main
- ⑥ Existing Concrete Utility Box
- ⑦ Potential Private Infrastructure Conflict, description per plan
- ⑧ Existing Bus Stop
- ⑨ Existing Irrigation Box
- ⑩ Proposed Signal Improvements
- ⑫ Proposed Box Tree, typical
- ⑬ Candidate Median Improvements
- ⑭ Pedestrian Scale Light
- ⑰ Existing Sidewalk

**Quantities**

①	③	4	⑬	1
②	③	0	⑭	20
④	③	0	⑰	17,691 sqft
⑤	③	0		
⑦		1		
⑩		1		
⑪		0		
⑫		14		

- 690 sqft (Outside RoW)
- 659 sqft (Inside RoW)
- 29 sqft (Inside Easement)

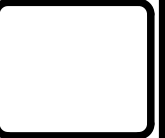
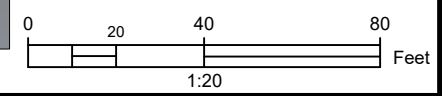

**Michael Baker**  
**INTERNATIONAL**

DESIGNED BY: SS	ISSUE DATE: 5/6/17	SOLICITATION NO.:	
DRAWN BY: SS		CONTRACT NO.:	
CHECKED BY: JF		SUBMITTED BY: JF	
		SIZE:	

**7ft Sidewalk**

SHEET ID  
**2**

**DRAFT**

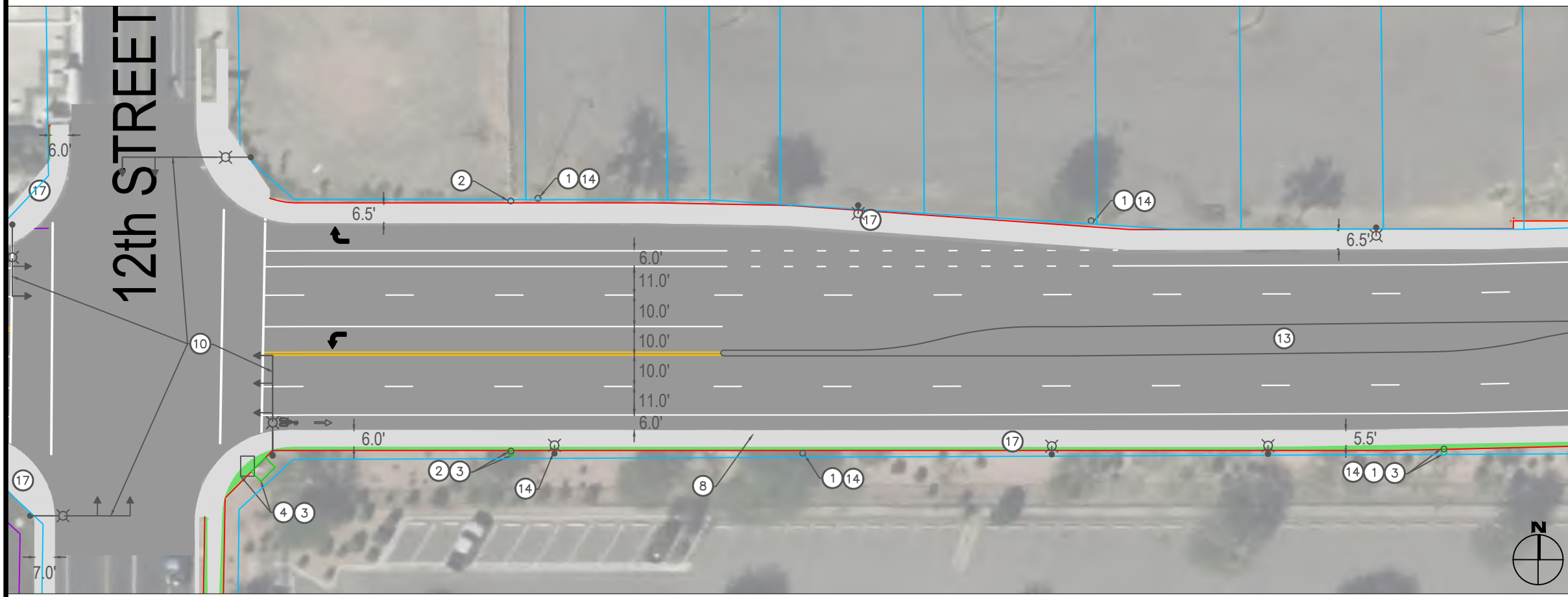
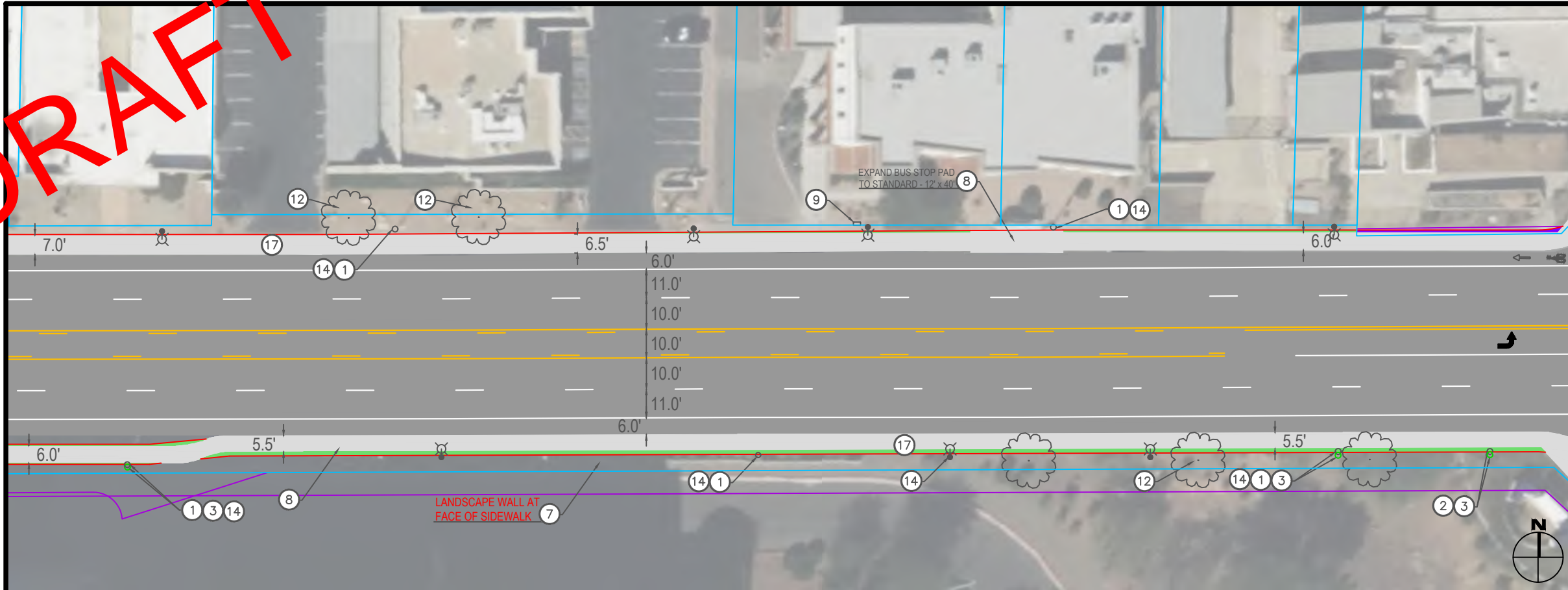

**Construction Notes**

- ① Existing Streetlight
- ② Existing Fire Hydrant
- ③ Relocate existing utility behind new sidewalk offset
- ④ Existing Traffic Signal Cabinet
- ⑤ Existing Water Main
- ⑥ Existing Concrete Utility Box
- ⑦ Potential Private Infrastructure Conflict, description per plan
- ⑧ Existing Bus Stop
- ⑨ Existing Irrigation Box
- ⑩ Proposed signal improvements
- ⑫ Proposed Box Tree, typical
- ⑬ Candidate median improvements
- ⑭ Pedestrian Scale Light
- ⑰ Existing Sidewalk

**Quantities**

- ① ③ 3      ⑬ 1
- ② ③ 2      ⑭ 21
- ④ ③ 1      ⑰ 14,458 sqft
- ⑤ ③ 0
- ⑦ 1
- ⑩ 1
- ⑪ 0
- ⑫ 5
- ⑬ 16 sqft (Outside RoW)
- ⑭ 1,751 sqft (Inside RoW)
- ⑮ 65 sqft (Inside Easement)

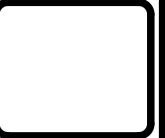
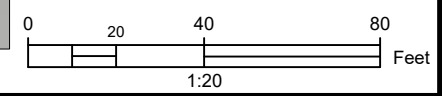

**Michael Baker**  
**INTERNATIONAL**

DESIGNED BY: SS	ISSUE DATE: 5/6/17	SOLICITATION NO.:	
DRAWN BY: SS		CONTRACT NO.:	
CHECKED BY: JF		SUBMITTED BY: JF	
		SIZE:	

**7ft Sidewalk**

SHEET ID  
**3**

**DRAFT**

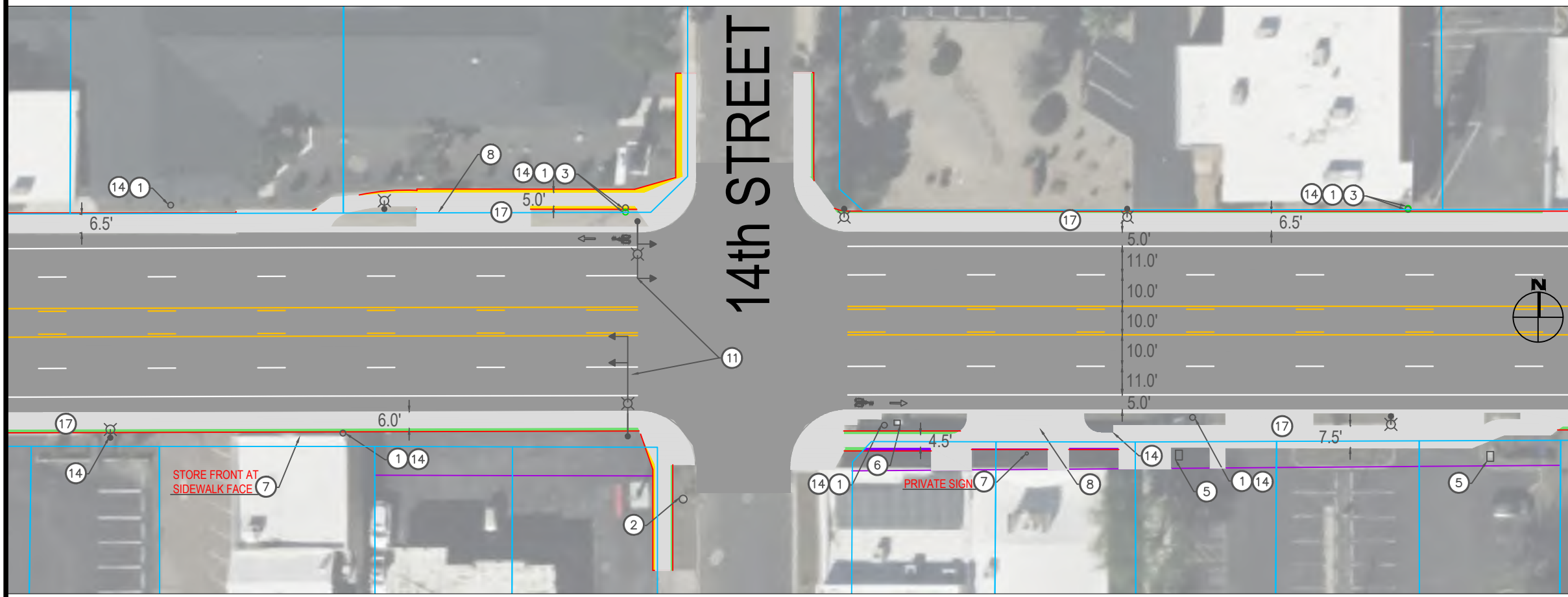

**Construction Notes**

- ① Existing Streetlight
- ② Existing Fire Hydrant
- ③ Relocate existing utility behind new sidewalk offset
- ④ Existing Traffic Signal Cabinet
- ⑤ Existing Water Main
- ⑥ Existing Concrete Utility Box
- ⑦ Potential Private Infrastructure Conflict, description per plan
- ⑧ Existing Bus Stop
- ⑨ Existing Irrigation Box
- ⑩ Proposed signal improvements
- ⑪ Proposed HAWK
- ⑫ Proposed Box Tree, typical
- ⑬ Candidate median improvements
- ⑭ Pedestrian Scale Light
- ⑰ Existing Sidewalk

**Quantities**

- ① ③ 3
- ② ③ 1
- ④ ③ 0
- ⑤ ③ 0
- ⑦ 4
- ⑩ 0
- ⑪ 1
- ⑭ 22
- ⑰ 17,512 sqft
- 514 sqft (Outside RoW)
- 994 sqft (Inside RoW)
- 53 sqft (Inside Easement)

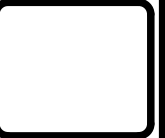
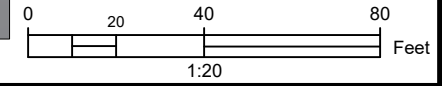

**Michael Baker  
INTERNATIONAL**

DESIGNED BY: SS	ISSUE DATE: 5/6/23
DRAWN BY: SS	SOLICITATION NO.:
CHECKED BY: JF	CONTRACT NO.:
SUBMITTED BY: JF	SIZE:

**7ft Sidewalk**

SHEET ID  
**4**

**DRAFT**

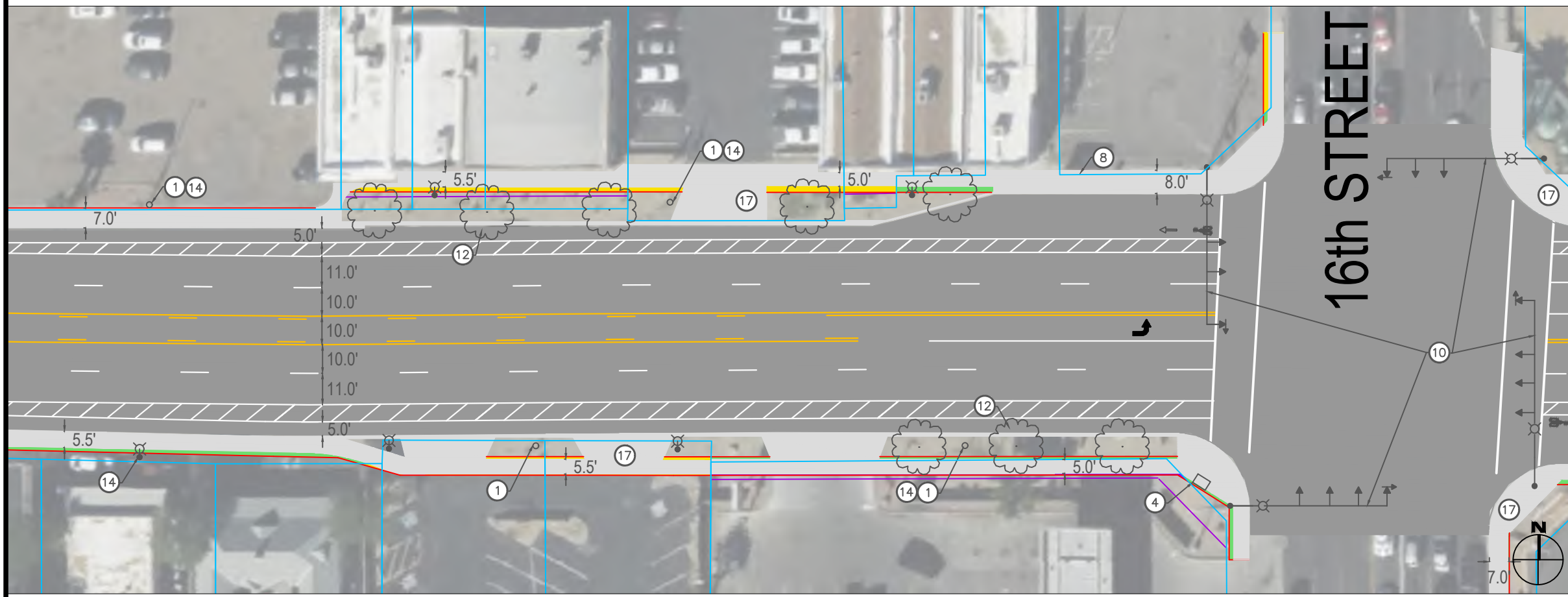
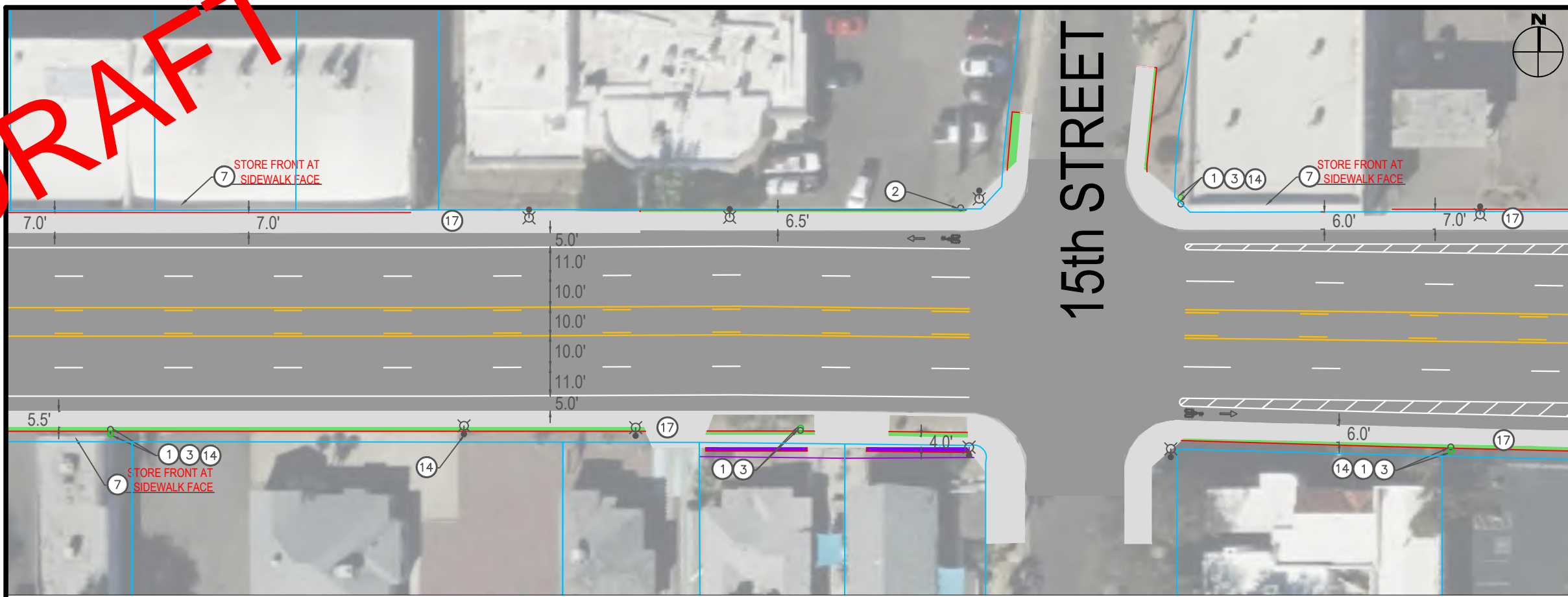

**Construction Notes**

- ① Existing Streetlight
- ② Existing Fire Hydrant
- ③ Relocate existing utility behind new sidewalk offset
- ④ Existing Traffic Signal Cabinet
- ⑤ Existing Water Main
- ⑥ Existing Concrete Utility Box
- ⑦ Potential Private Infrastructure Conflict, description per plan
- ⑧ Existing Bus Stop
- ⑨ Existing Irrigation Box
- ⑩ Proposed signal improvements
- ⑫ Proposed Box Tree, typical
- ⑭ Pedestrian Scale Light
- ⑰ Existing Sidewalk

**Quantities**

- ① ③ 4
  - ② ③ 0
  - ④ ③ 0
  - ⑤ ③ 0
  - ⑦ 3
  - ⑩ 1
  - ⑪ 0
  - ⑫ 8
  - ⑭ 20
  - ⑰ 17,151 sqft
- 426 sqft (Outside RoW)  
 1155 sqft (Inside RoW)  
 96 sqft (Inside Easement)

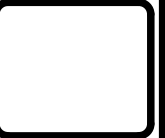
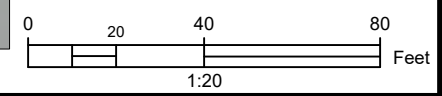

**Michael Baker**  
**INTERNATIONAL**

DESIGNED BY: SS	ISSUE DATE: 5/6/23
DRAWN BY: SS	SOLICITATION NO.:
CHECKED BY: JF	CONTRACT NO.:
SUBMITTED BY: JF	SIZE:

**7ft Sidewalk**

SHEET ID  
**5**

**DRAFT**

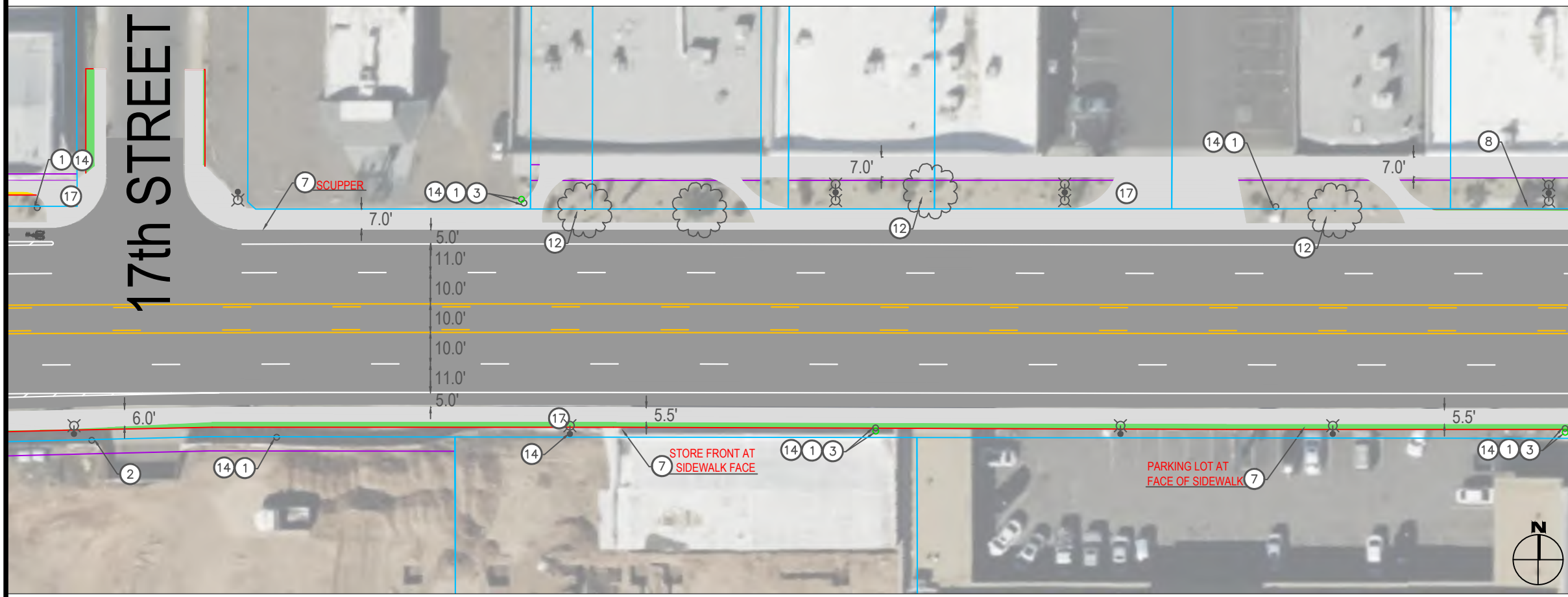
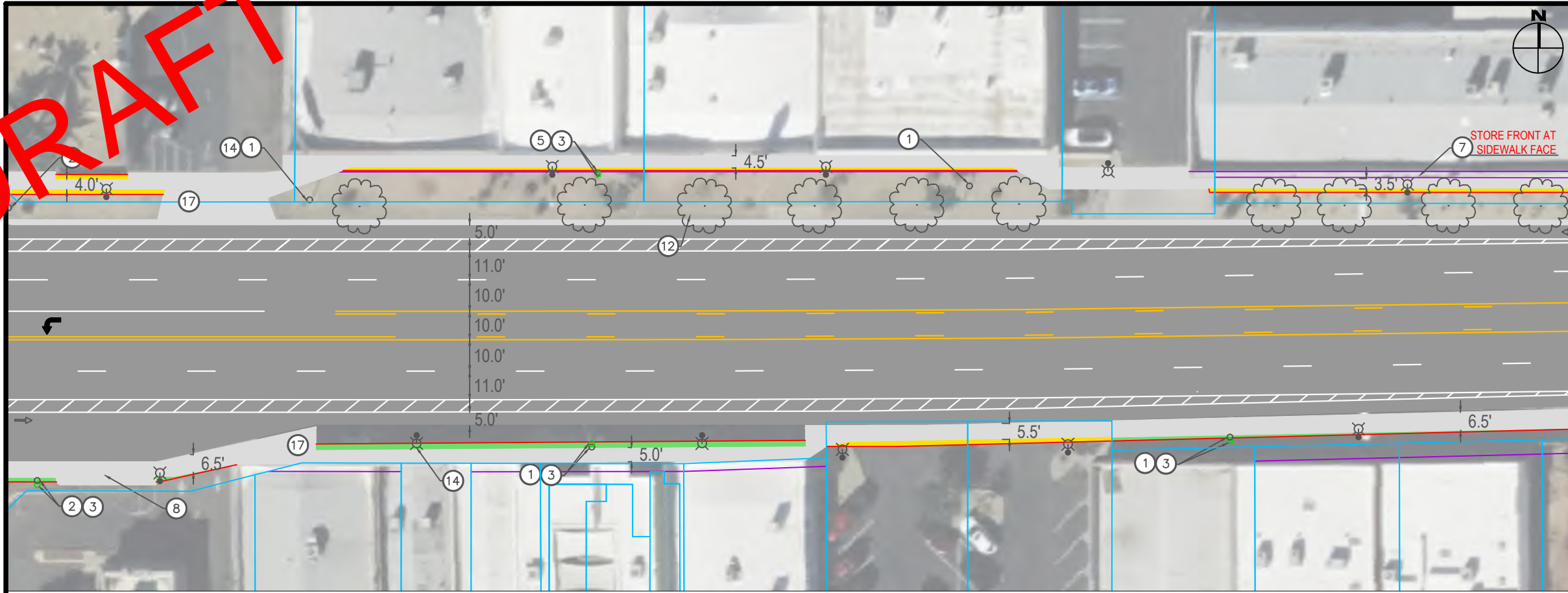

**Construction Notes**

- ① Existing Streetlight
- ② Existing Fire Hydrant
- ③ Relocate existing utility behind new sidewalk offset
- ④ Existing Traffic Signal Cabinet
- ⑤ Existing Water Main
- ⑥ Existing Concrete Utility Box
- ⑦ Potential Private Infrastructure Conflict, description per plan
- ⑧ Existing Bus Stop
- ⑨ Existing Irrigation Box
- ⑩ Proposed signal improvements
- ⑫ Proposed Box Tree, typical
- ⑭ Pedestrian Scale Light
- ⑰ Existing Sidewalk

**Quantities**

- ① ③ 5
  - ② ③ 1
  - ④ ③ 0
  - ⑤ ③ 1
  - ⑦ 4
  - ⑩ 0
  - ⑪ 0
  - ⑫ 14
  - ⑭ 26
  - ⑰ 17,385 sqft
- 632 sqft (Outside RoW)  
 1551 sqft (Inside Row)

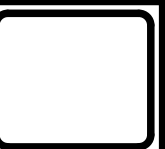
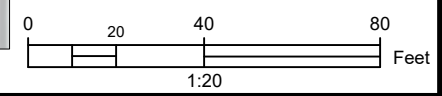

**Michael Baker**  
INTERNATIONAL

DESIGNED BY: SS	ISSUE DATE: 5/6/23
DRAWN BY: SS	SOLICITATION NO.:
CHECKED BY: JF	CONTRACT NO.:
SUBMITTED BY: JF	SIZE:

**7ft Sidewalk**

SHEET ID  
**6**





**DRAFT**

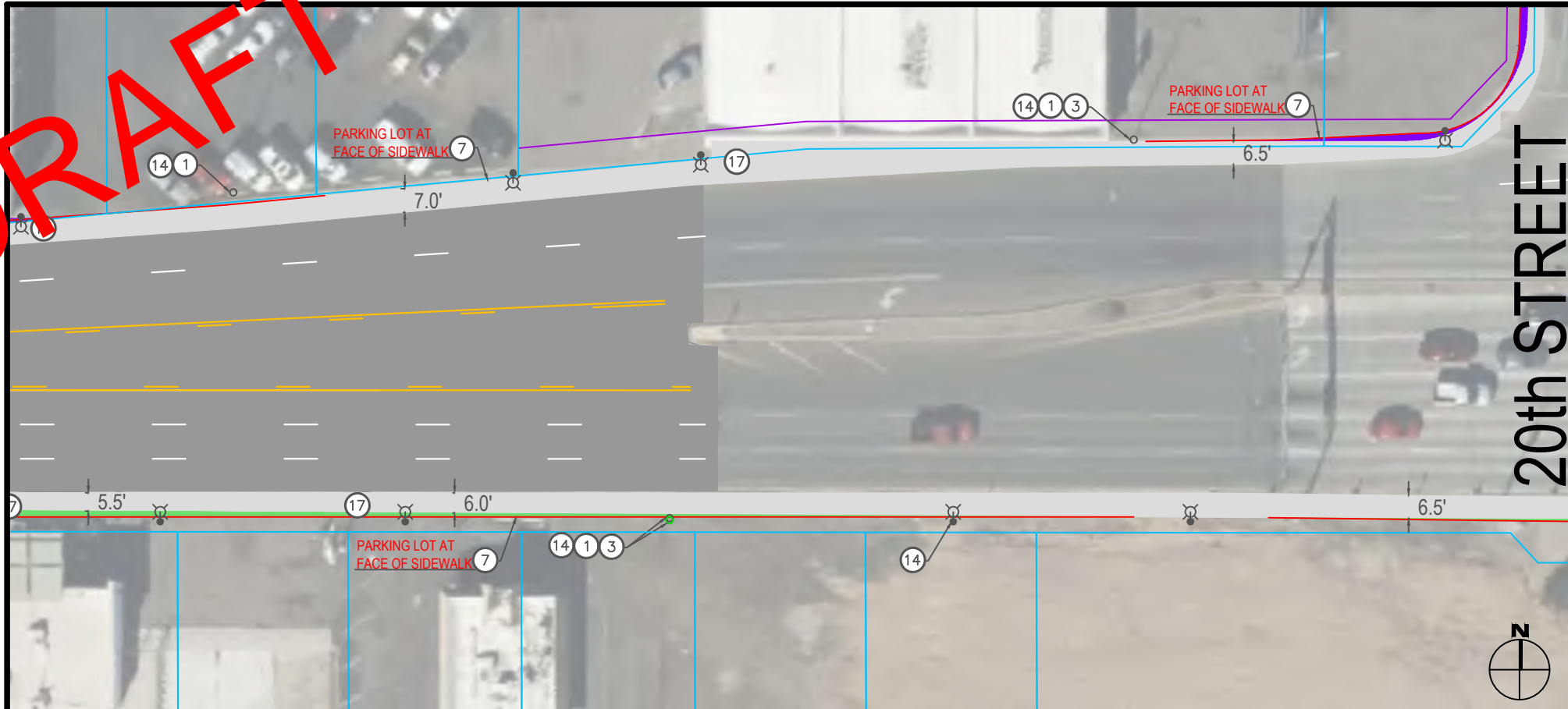

**Construction Notes**

- ① Existing Streetlight
- ② Existing Fire Hydrant
- ③ Relocate existing utility behind new sidewalk offset
- ④ Existing Traffic Signal Cabinet
- ⑤ Existing Water Main
- ⑥ Existing Concrete Utility Box
- ⑦ Potential Private Infrastructure Conflict, description per plan
- ⑧ Existing Bus Stop
- ⑨ Existing Irrigation Box
- ⑩ Proposed signal improvements
- ⑭ Pedestrian Scale Light
- ⑰ Existing Sidewalk

**Quantities**

- ① ③ 1      ⑭ 8
- ② ③ 0      ⑰ 5,145 sqft
- ④ ③ 0
- ⑤ ③ 0
- ⑦ 3
- ⑩ 0
- ⑪ 0
- ① 0 sqft (Outside RoW)
- ② 180 sqft (Inside RoW)
- ③ 137 sqft (Inside Easement)

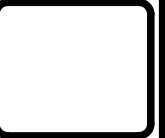
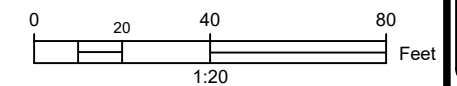

**Michael Baker**  
**INTERNATIONAL**

DESIGNED BY: SS	ISSUE DATE: 5/6/23
DRAWN BY: SS	SOLICITATION NO.:
CHECKED BY: JF	CONTRACT NO.:
SUBMITTED BY: JF	SIZE:

**7ft Sidewalk**

SHEET ID  
**8**